

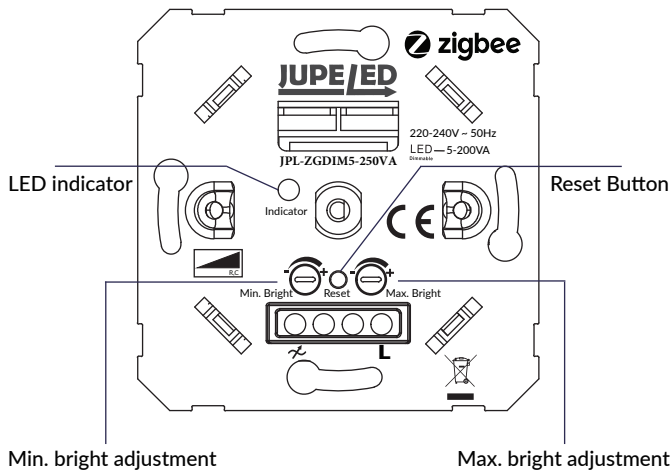

JPL-ZGDIM5-200VA

Zigbee 3.0 Rotary Dimmer



Features

- ✓ Zigbee support
- ✓ Voice support (Amazon Alexa & Google Assistant Home)
- ✓ Suitable for several home automation apps
- ✓ Support TouchLink, Find and bind
- ✓ Push / turn button
- ✓ Suitable for 5-200W LED
- ✓ Suitable for all well-known brands of cover frames
- ✓ Optimal dimmable & light stability
- ✓ MIN and MAX light adjustment options
- ✓ Suitable for 90% of all LEDs
- ✓ Installation with provided 2 wires (no neutral wire required)
- ✓ Soft start system
- ✓ Noiseless dimming
- ✓ Suitable for surface-mounted boxes & flush-mounted boxes with or without screw holes

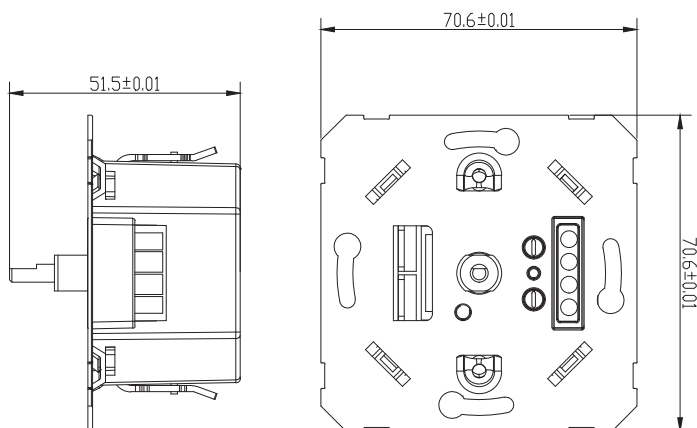

1. Technical data

Rated Voltage	230V ~ 50Hz
LED Power	200VA
Input current	0.87A
Controls	Push on/off, Rotary Dim
Dimming Technology	Trailing Edge
Control Mode	One Way
Support load type	Dimmable LEDs Incandescent HV Halogen
Protocol	Zigbee 3.0
Operating Temp.	-20 °C~40°C
Dimension	70.6x70.6x33mm

2. Installation

WARNING: Read all Instructions Prior to Installation.

- Step 1. Disconnect power to the relevant circuit at the main switchboard.
- Step 2. Remove existing switch from wall.
- Step 3. Connect the dimmer in accordance with the wiring diagrams shown below.
- Step 4. Refit switch plate to wall.
- Step 5. Reconnect power.
- Step 6. Turn switch on and check dimmer operation by turning control knob through full range.

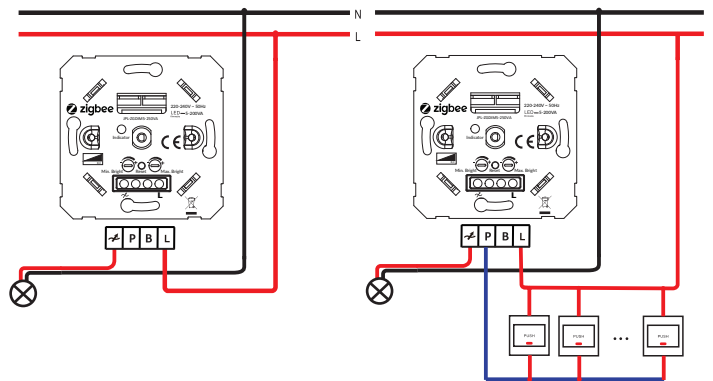

Please note: This Zigbee Dimmer Switch is only suitable for One way Connection.

3. Operation

1) Min. Bright & Max. Bright Adjustment.

To ensure the dimmer to work optimally, you can adjust the lights brightness at min./max. from the dimmer with the MIN and MAX adjustment.

Min. bright adjustment
When the light is on and at the previous set min. level, Anti-clockwise the VR to decrease or clockwise to increase the brightness at the min. level to your preference, and avoid flickering as well.

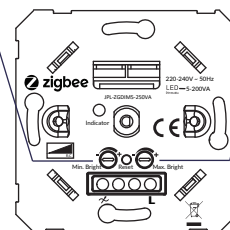

Max. bright adjustment
When the light is on and at the previous set max. level, Anti-clockwise the VR to decrease or clockwise to increase the brightness at the max. level to your preference, and avoid flickering as well.

2) Factory Reset

Step 2. When the Indicator stay in Red for 10s, reset finished.

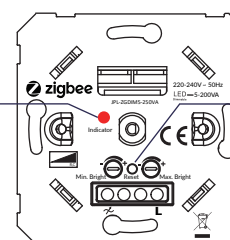

Step 1. Press the reset button for 5s.

Please Note: All configuration will be reset after the device is reset or remove from the network.

3) Inclusion to the Zigbee Network

Step 1. Remove the device from previous Zigbee network if it has already been added to, otherwise pairing mode will be fail.

Step 2. From your Zigbee Controller interface, choose to add lighting and enter the pairing mode.

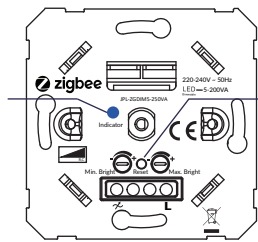

Step 4. The indicator will start blinking blue and stay solid for 10s when pairing succeed, timeout 15mins.

Step 3. Double Press the reset button.

4) Exclusion from the Zigbee Network

Method 1. From your Zigbee hub interface, choose to delete or reset the device as instructed.

Method 2. Remove from the Device, see below instructions.

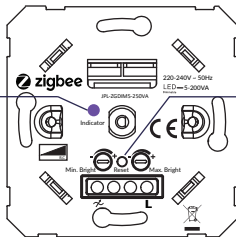

Step 2. The indicator will start blinking purple and stay solid for 10s when remove done, timeout 3mins.

Step 1. Press the reset button for 3 times.

5) TouchLink Reset/remove both device from Zigbee Network.

Step 1. Remove the device if it is included in a Zigbee network before activate TouchLink.

Step 3. The indicator will start blinking green and stay solid for 10s when pairing succeed, timeout 15mins.

Step 4. Bring the remote within 10cm of the smart dimmer and set the remote into TouchLink commissioning.

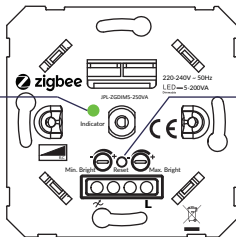

Step 2. Press the reset button for 4 times.

Note:

- a. When both devices (Dimmer and remote) not included in the Zigbee Network, each dimmer can link with one remote max.
- b. When both devices are included in the same Zigbee network, each dimmer can link with max 30 remotes.
- c. For Hue Bridge & Amazon Echo Plus, add remote and device to network first then TouchLink.

6) Find and Bind Mode

Step 1. Make sure the device and remote already added to the same Zigbee network.

Step 3. The indicator will start blinking yellow and stay solid for 10s.

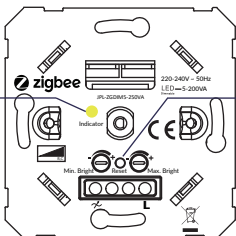

Step 2. Press the reset button for 5 times.

4. Zigbee clusters the device supports are as below

1) Input Cluster

- 0x0000: Basic
- 0x0003: Identify
- 0x0004: Groups
- 0x0005: Scenes
- 0x0006: On/off
- 0x0008: Level Control
- 0x0b05: Diagnostics

2) Output Cluster

- 0x0019: OTA

5. Support hub/platform

Suitable for most Zigbee hubs / apps:

- ✓ Google Assistant/Google Home
- ✓ Amazon Alexa
- ✓ Philips Hue
- ✓ Trust

PHILIPS
hue
personal wireless lighting



Please refer to Corresponding hub manual /instruction to learn how

6. Safety

- ! DO NOT Install with power applied to device
- ! DO NOT expose the device to moisture.
- ! DO NOT open the dimmer in case any damages that out of repair.

7. Warranty

Within 2 years after sold, any faults caused by non-artificial reason we should maintain it freely.

8. Declaration of conformity

We hereby certified that the device satisfies the previsions for CE/ Nem-ko marking in accordance with the EU directives(LV Directive 2014/35/EU, EMC Directive 2014/30/EU, RoHS Directive(EU) 2015/863 amending 2011/65/EU) as described below.

EMC Standard(EMC)

EN 60669-2-1: 2004+A1:2009+A12:2010(Clause 26)

EN 55015: 2013+A1:2015

EN 61000-3-2:2014

EN 61000-3-3:2013

EN 61547:2009

EN 62493:2015

Safety Standard(LVD)

EN 60669-2-1: 2004 +A1:2009+A12:2010

EN 60669-1: 2018

RoHS Standard(RoHS)

Directive(EU)2015/863 amending 2011/65/EU